

MECHANICAL:

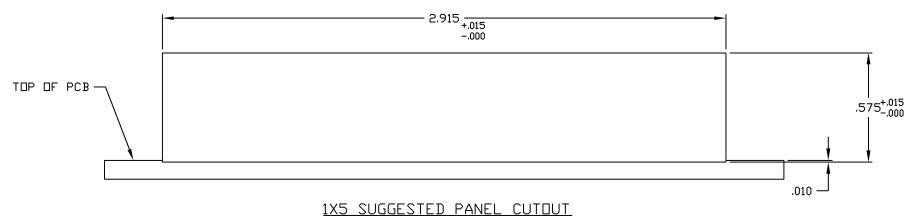
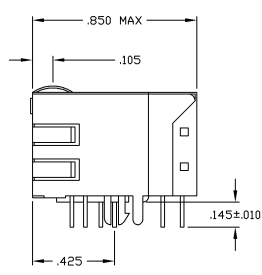
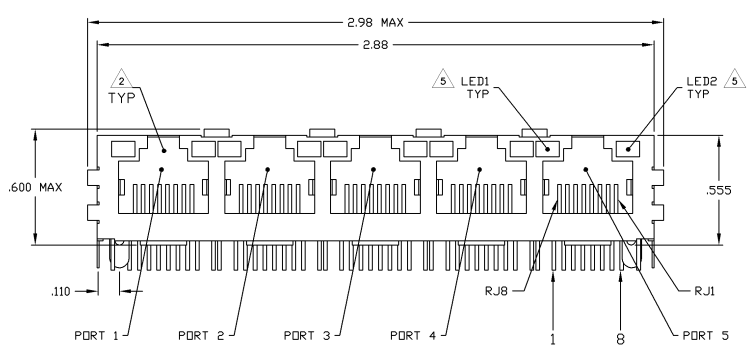
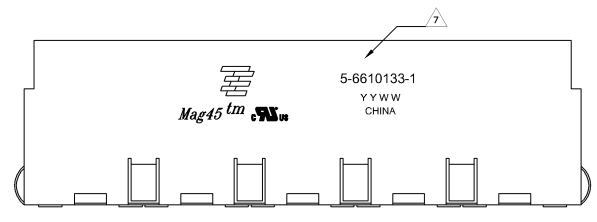

- 1 MATERIALS:  
HOUSING - THERMOPLASTIC PET POLYESTER FLAMMABILITY RATING UL 94V-0  
SHIELD - .010" THICK 20000 BRASS PLATED WITH 100µINCH MIN SEM-BRIGHT NICKEL  
SOLDER TABS POST DIPPED WITH 100µINCH MIN SAC SOLDER  
MOD JACK CONTACTS - 0.057 X 0.038" PHOSPHOR BRONZE, 50µINCH MIN OVERALL NICKEL UNDERPLATE WITH SELECT 50µINCH MIN HARD GOLD FLASH PLATE  
SOLDER TAILS WITH 100µINCH MIN MATE TIN AND/OR SAC SOLDER DIP  
- LIGHT EMITTING DIODE(LEDS) - DIFFUSED EPOXY LENS, .020" X .020" CARBON STEEL  
- WIRE FRAME LEADS PRE-PLATED WITH BRASS/SILVER OVER CARRIER NICKEL UNDERPLATE OVER 40µINCH COPPER UNDERPLATE, POST-PLATED WITH 100µINCH MIN MATE TIN AND/OR SAC SOLDER DIP OR PURE TIN SOLDER DIP
- 2 R45 JACK CAVITY CONFORMS TO FCC RULES AND REGULATIONS PART 68, SUB PART F
- 3 MAGNETICS:  
- IMPEDANCE: 150 OHMS  
- TURNING RATIO (CRP CABLE): TX = 11, RX = 11  
- OPEN CIRCUIT INDUCTANCE (OCL): 35µH MIN @ 100MHz, 0 IV RMS  
- SWR: 1.25 MAX FROM 0% TO 100% TX AND RX PERFORMANCE @ 35%  
- INSERTION LOSS (IL): 1.1dB MAX FROM 0.5MHz TO 100MHz  
- RETURN LOSS (RL): 18dB MIN FROM 0.5MHz TO 30MHz  
- IS-20 LOSS/30dB MIN FROM 36 MHz TO 60MHz  
- 12dB MIN FROM 60 MHz TO 80MHz  
- CROSSTALK ATTENUATION: 35dB MIN FROM 0.5MHz TO 4.0MHz  
- 33-20µLOG/50dB MIN FROM 4.0 MHz TO 100MHz  
- COMMON MODE REJECTION RATIO (CMRR): 30dB MIN FROM 0.5MHz TO 100MHz  
- ISOLATION VOLTAGE: COMPLIES WITH IEEE802.3 DQZ, PARA 23.5.1.1, 104M10
- 4 OPERATING TEMPERATURE FROM 0°C TO +70°C
- 5 LEADS WITH BUILT-IN RESISTOR  
- LEADS ARE DRIVEN WITH 5V VOLTAGE AND THE MAX OPERATING CURRENT IS 20mA  
- LED COLOR DOMINANT WAVELENGTH (NM): GREEN 568 nm TYP @ VF=5V  
- FORWARD CURRENT (IF): GREEN 12mA TYP @ VF=5V  
- DOMINANT WAVELENGTH (NM): YELLOW 588 nm TYP @ VF=5V  
- FORWARD CURRENT (IF): YELLOW 10mA TYP @ VF=5V
- 6 INDICATED CONNECTIONS ARE FOR NIC CONFIGURATION. THE MAGNETICS ARE ASYMMETRIC, AND DO NOT SUPPORT AUTO-HOT/HDXX.
- 7 TYCO ELECTRONICS LOGO, PART NUMBER, DATE CODE, COUNTRY OF ORIGIN AND AGENCY APPROVAL MARKING IN APPROXIMATE LOCATION SHOWN.
- 8 THE PART IS RECOMMENDED FOR WAVE SOLDERING PROCESS. PREHEAT TEMPERATURE IS 120°C TO 160°C, 12X SECONDS TO 180 SECONDS. PEAK WAVE SOLDERING TEMPERATURE IS 260°C MAX, 10 SECONDS MAX.

GREEN	YELLOW	5-6610133-1
LED1	LED2	PART NUMBER

THIS DRAWING IS A CONTROLLED DOCUMENT

DESIGNED BY	DATE	REVISED BY	DATE	REVISED BY	DATE

1X5 MAG45(TM) MODULAR JACK, 7W2 SCHEMATIC, 17 SERIES CIRCUIT, DECOUPLING CAPACITOR, SHIELDED, WITH GREEN/YELLOW RESISTOR LEADS

SCALE: 4:1

CUSTOMER DRAWING

717 SERIES MAGNETIC CIRCUIT

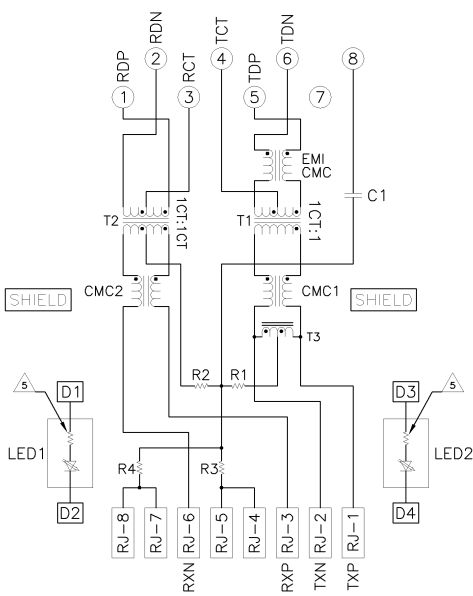

C1 = 1000pF, 2kV CAPACITOR  
 R1-R4 = 75 OHMS, 1/16 W RESISTORS

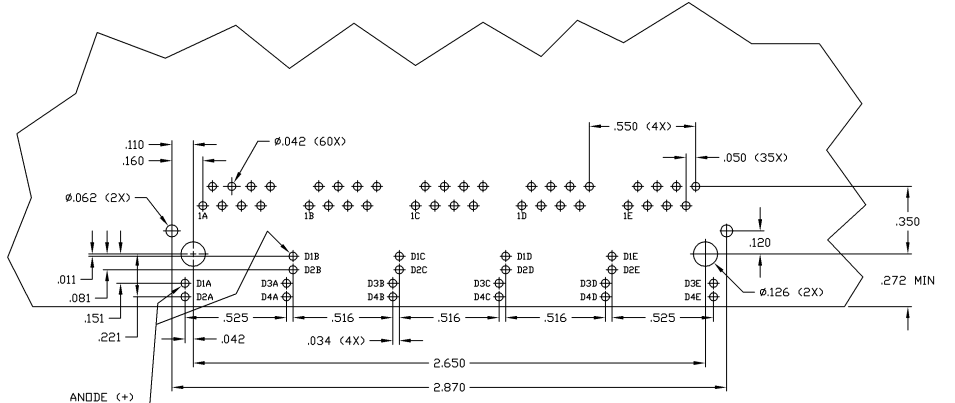
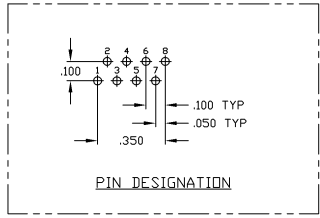

SUGGESTED PCB LAYOUT  
 (Component Side)

THIS DRAWING IS A CONTROLLED DOCUMENT		REV	DATE	BY	CHKD	APP'D
1	REVISED					
2	REVISED					

DESIGNER	DATE	REV	DATE	BY	CHKD	APP'D

PROJECT	DESCRIPTION	SCALE	SHEET	TOTAL
A1	717 SERIES MAGNETIC CIRCUIT	4:1	2	2

Customer Drawing